

THE FORTRESS

The scale model at information station no.2 shows how three constructions are embedded in this space. In the centre is a rectangular building with a tower at each corner. It was built in about 200AD and perhaps served as a military storehouse. Nearby were two bath houses: more can be learned about them at station no. 3.

An earthen rampart surmounted by a fence and surrounded by a ditch was added in about 290 AD.

The outside wall was begun around 295 AD and would have transformed this site into a military camp, but it was never completed.

Audioguides 201 to 213

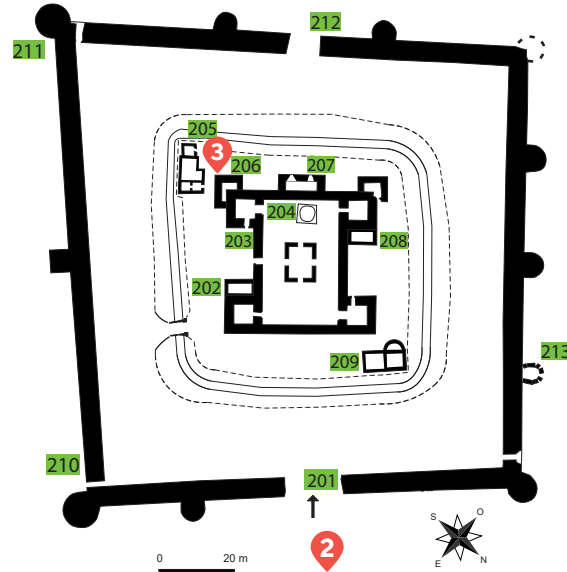

THE THEATRE

The vestiges of two theaters overlap on this site. Use the sliding plans at station 4 to tell them apart.

The 1st century theatre is small, almost circular. The theater of the 2nd century is larger and its big arena, bound by wooden posts, may have welcomed performances by gladiators.

Audioguides 401 to 404

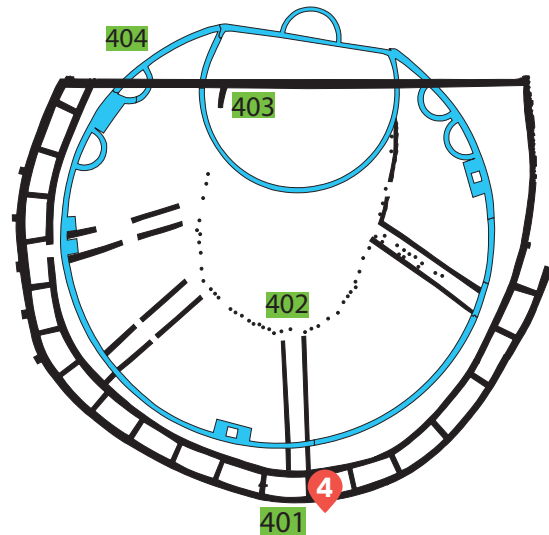

THE THERMAL BATHS

The thermal baths included rooms for bathing, but also shops, a portico and a palestra for combat sports. The plan of all these spaces is indicated on the ground around you. In the church, a sound and light presentation will accompany your visit to the thermal baths.

Audioguides 301 to 302

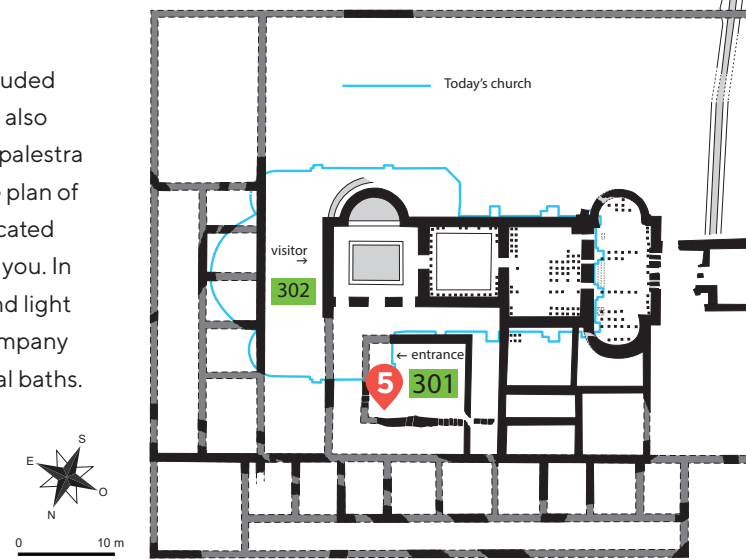

Audioguides 601 to 607

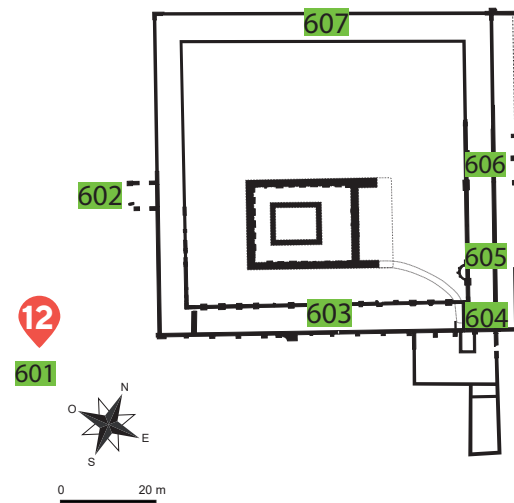

THE TEMPLE

Station 11 presents the principal Diablinte temple. More understanding of these remains can be accessed at station 12. This Gallo-Roman sanctuary is bound by a sacred enclosure. Inside is the temple itself, once housing a statue of the divinity. What we can see today corresponds to the foundation of the temple podium. This platform was originally covered with a facing of fine limestone blocks.

ARCHAEOLOGICAL MUSEUM AND SITE OF JUBLAINS

JUBLAINS IN ROMAN TIMES

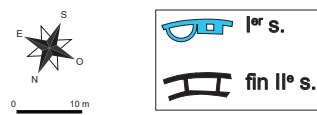
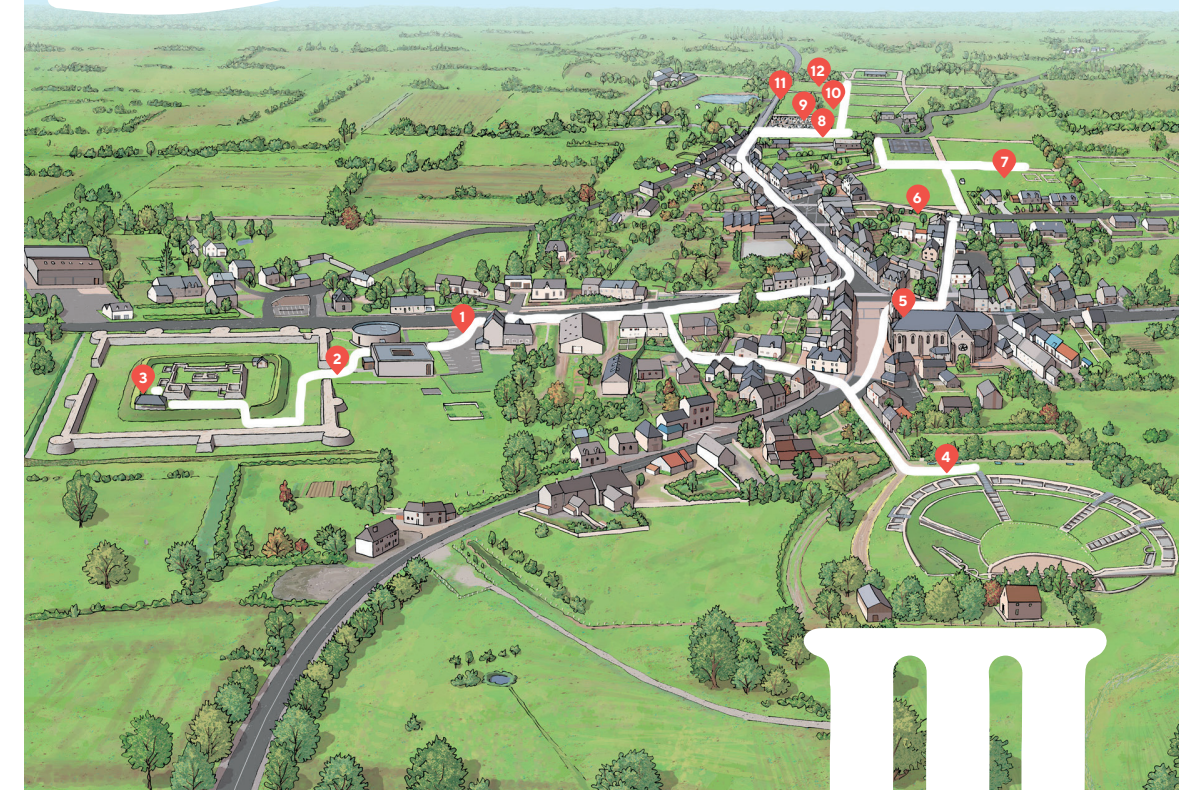

Course design: Conseil général de la Mayenne - Museology and graphic design: Sylvie et Joël Jupin - Comic refunds: Alex Evang and Yves Plateau. Achievement: BOSCHER Signalétique, Tactile Studio, Fonderie d'Art Macheret - English translation: Roxanne Flornoy

Musée archéologique départemental
02 43 58 13 20 - musee.jublains@lamayenne.fr

www.museedejublains.fr



JUBLAINS
CITÉ ANTIQUE



UN SITE DU CONSEIL DÉPARTEMENTAL DE LA MAYENNE

YOUR ITINERARY

WELCOME TO NOVIODUNUM!

The archaeological museum and site welcome you to explore the **Roman capital of the Diablintes**. Follow the path from the museum to the different monuments along an itinerary accessible to all. This track is adapted to wheelchairs and baby strollers. It is about 3,5 km long and meant to be covered on foot. There are, however, parking places at different points within the site; these are indicated on the general map.

It is advised to begin with a visit to the museum and the fortress. The rest is for you to explore, along a path which leads from the theatre to the temple, by way of the thermal baths and the archeological site. The baths keep the same hours as the museum.

To situate yourself in Jublains, **follow the bronze discs** which mark the way and lead to **12 information points**.



AUDIOGUIDE

For more information, an audioguide is available at the museum reception desk (2 €). To use your audioguide, type in the number of the information panel, then press "play" (Language codes are 951: French; 952: English; 953: German)



	Information stations		Toilets
	Parking		Handicapped parking
	Audioguide commentary number		Visit itinerary
	picnic table		Today's town

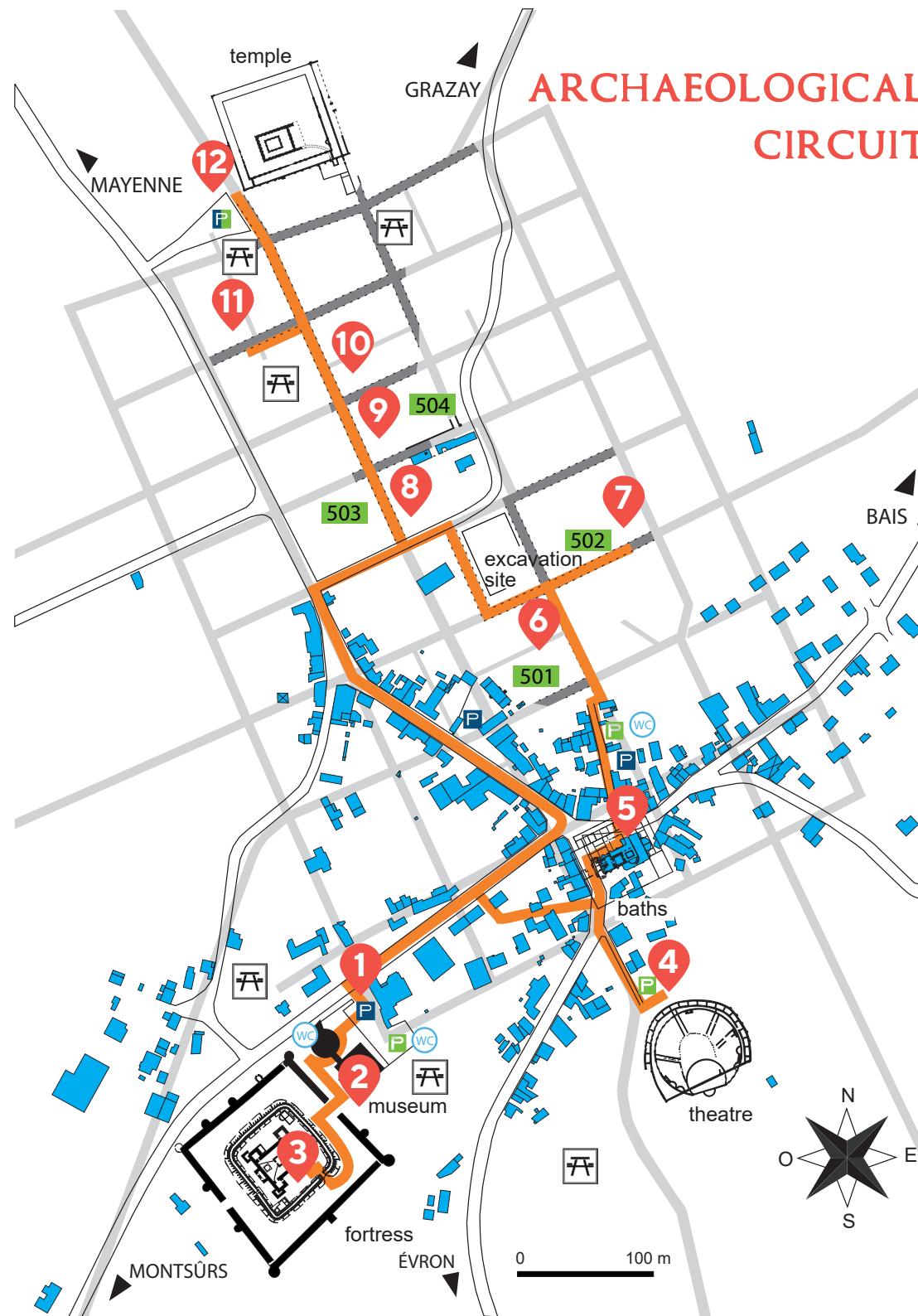

THE MUSEUM

The museum stands next to the fortress and synthesizes what we've learned about the Gallic and Roman periods in Mayenne. Studying the city of Noviodunum is central to its mission.

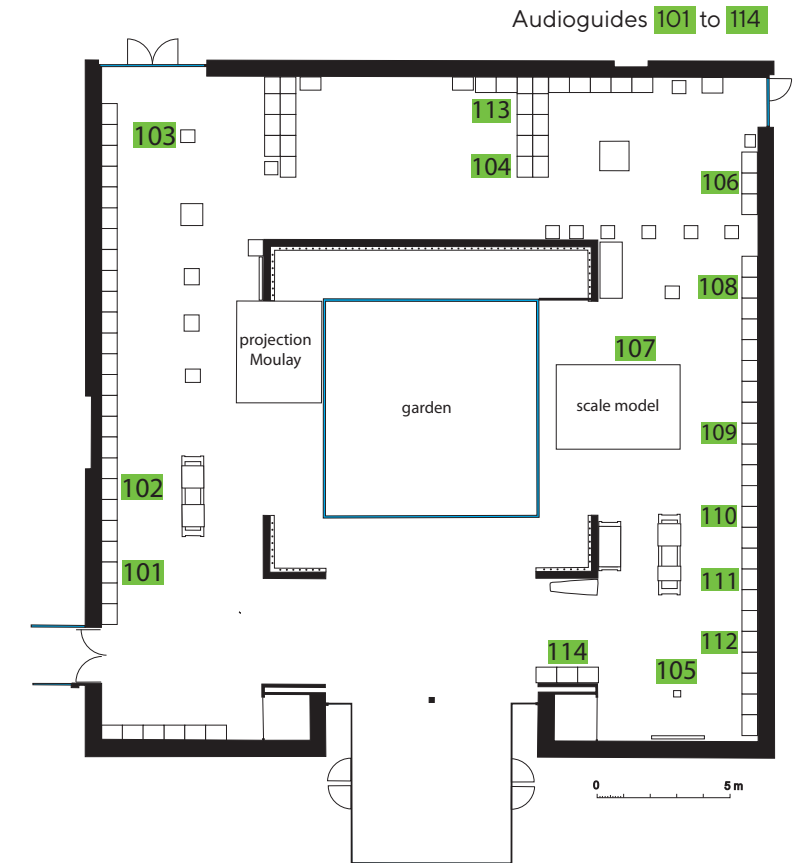

THE ARCHAEOLOGICAL CIRCUIT

Audioguides **501 to 504**

Here, big grassy spaces constitute both a plan and an archaeological reserve.

Sandy paths mark the position of antique streets. Every «square» of lawn corresponds to a block, a quarter of the antique city.

You will pass near an artisans' district, a townhouse (domus) under excavation and the forum. These vestiges are not visible, but are presented at the information stations.